

# MicroClear™

## VERTICAL GRID D.E. FILTER SERIES REPLACEMENT PARTS

### Parts Diagram

Filters

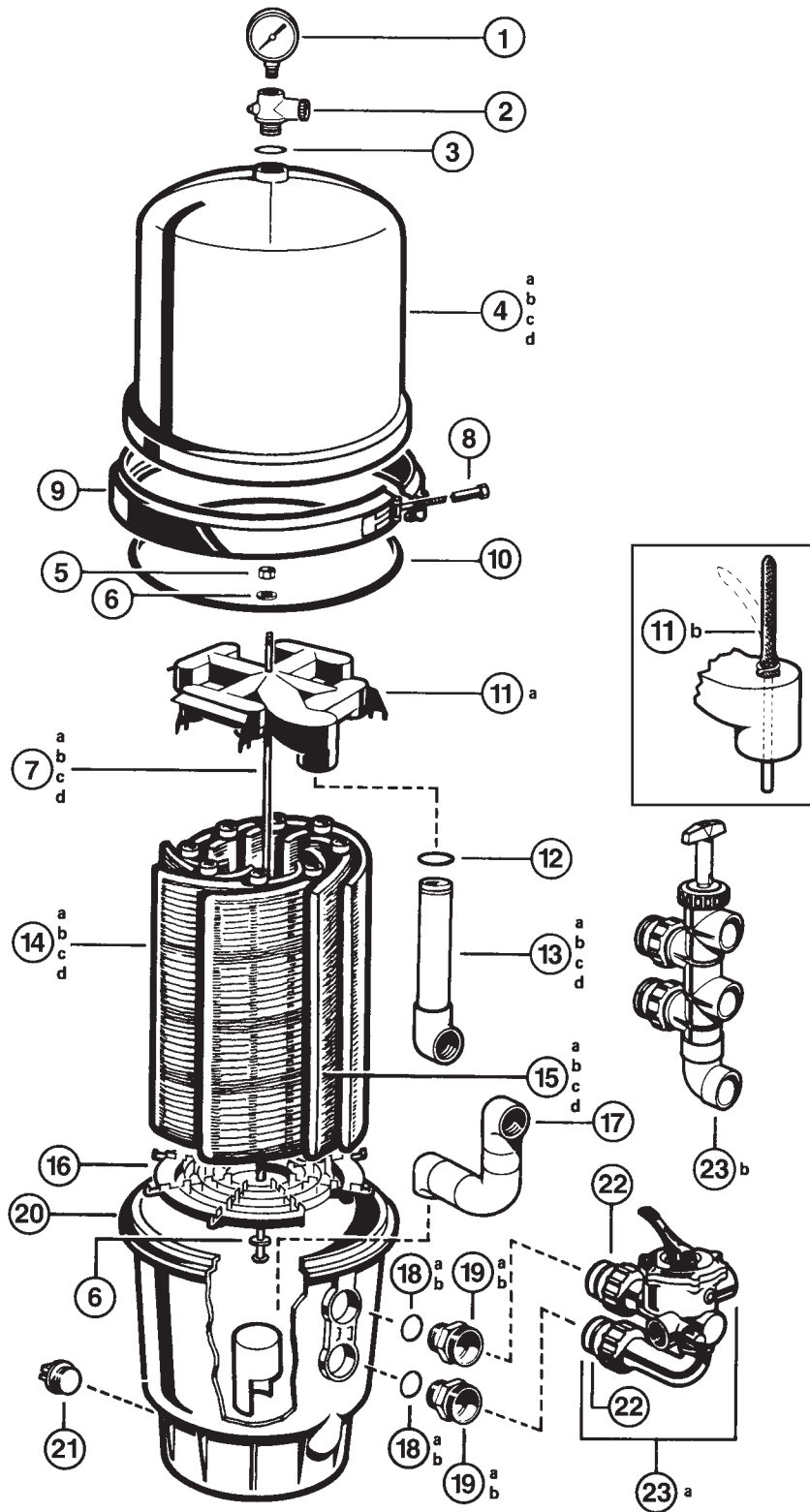

### Parts Listing

Ref. No.	Part No.	Description	Ctn. Qty.	No. Req'd
1	ECX270861	Pressure Gauge	50	1
2	DEX2400S	Relief Valve/Gauge Adapter Assembly	100	1
—	DEX2400Z3A	O-Ring for Relief Valve Stem ( <i>Set of 3</i> )	100	1
3	SX200Z5	Relief Valve Assembly O-Ring	50	1
4a	DEX2400BT	Filter Head (DE2400)	—	—
4b	DEX3600BT	Filter Head (DE3600)	—	—
4c	DEX4800BT	Filter Head (DE4800)	—	—
4d	DEX6000BT	Filter Head (DE6000)	—	—
5	ECX176865	Retainer Nut, 5/16" – 18	25	1
6	ECX1109	Washer, 5/16"	10	2
7a	DEX2400R	Retainer Rod (DE2400)	5	1
7b	DEX3600R	Retainer Rod (DE3600)	5	1
7c	DEX4800R	Retainer Rod (DE4800)	5	1
7d	DEX6000R	Retainer Rod (DE6000)	5	1
8	DEX2400JN	Brass Sleeve Nut, 5/16" – 24	—	—
9	DEX2400J	Clamp Assembly with Spring Assemblies	—	—
10	DEX2400K	Filter Tank O-Ring	—	—
11a	DEX2400C	Top Collector Manifold with Flex Air Relief	1	1
11b	DEX2400CR	Flex Air Relief Assembly	50	1
12	DEX2400Z5	Outlet Elbow O-Ring	500	1
13a	DEX2400EAB	Outlet Elbow Assembly (DE2400)	—	—
13b	DEX3600EAB	Outlet Elbow Assembly (DE3600)	—	—
13c	DEX4800EAB	Outlet Elbow Assembly (DE4800)	—	—
13d	DEX6000EAB	Outlet Elbow Assembly (DE6000)	—	—
14a	DEX2400DA	Filter Element (DE2400)	10	7
14b	DEX3600DA	Filter Element (DE3600)	10	7
14c	DEX4800DA	Filter Element (DE4800)	10	7
14d	DEX6000DA	Filter Element (DE6000)	10	7
15a	DEX2400DS	Filter Element – Short (DE2400)	10	1
15b	DEX3600DS	Filter Element – Short (DE3600)	10	1
15c	DEX4800DS	Filter Element – Short (DE4800)	10	1
15d	DEX6000DS	Filter Element – Short (DE6000)	10	1
16	DEX2400H	Filter Element Locator	1	1
17	DEX2400GAB	Inlet Elbow Assembly	—	—
18a	SX200Z3	O-Ring (1995 and Prior)	50	2
18b	SX360Z1	O-Ring (1996- )	25	2
19a	DEX360F	Bulkhead Fitting	—	—
19b	DEX360FB	Buttress Thread Bulkhead Fitting	—	—
20	DEX2400A1T	Filter Body	—	—
21	SP1022CBLK	1 1/2" Drain Plug with O-Ring	100	1
22	SX200Z4PAK2	Valve/Union O-Ring ( <i>Set of 2</i> )	25	1
23a	SP0710XR50	Vari-Flo Valve Assembly – 1 1/2" NPT	1	1
—	SP0715XR50	Vari-Flo Valve Assembly – 2" NPT	1	1
—	SP0740DE	Selecta-Flo Valve Assembly – 2" SKT	1	1
23b	SP0410X502S	Slide Valve Assembly – 2" SKT	1	1
—	DEX2400DC*	Filter Element Cluster Assembly (DE2400)	1	1
—	DEX3600DC*	Filter Element Cluster Assembly (DE3600)	1	1
—	DEX4800DC*	Filter Element Cluster Assembly (DE4800)	1	1
—	DEX6000DC*	Filter Element Cluster Assembly (DE6000)	1	1

**NOTE:** \*Assembled set of filter elements, manifold, flex air relief, retainer rod and element locator.